



JOHN AND JEAN MULDER RESERVE OPTION 1

www.activediscovery.net.au



















EQUIPMENT KEY		
NO.	CODE	EQUIPMENT NAME
1	PM12	MULTIPLAY UNIT
2	CA 150-15	CAROUSEL
3	RE 242-99	GROUP ROCKER
4	RE 214-15	SNAKE ROCKER

LANDSCAPING CALCS	
261m²	SOFTFALL - PLAYMATT
66m	LIMESTONE EDGING LINEAR

COMPONENT COLOUR PALLETE (FOR PM COMPONENTS ONLY)		
UPRIGHT COLOUR	JASPER	
COMPONENT COLOUR 1	JUICY LIME	
COMPONENT COLOUR 2	PALE EUCALYPT	
COMPONENT COLOUR 3	LEAF	
PLASTICS COLOUR 1	GREEN	

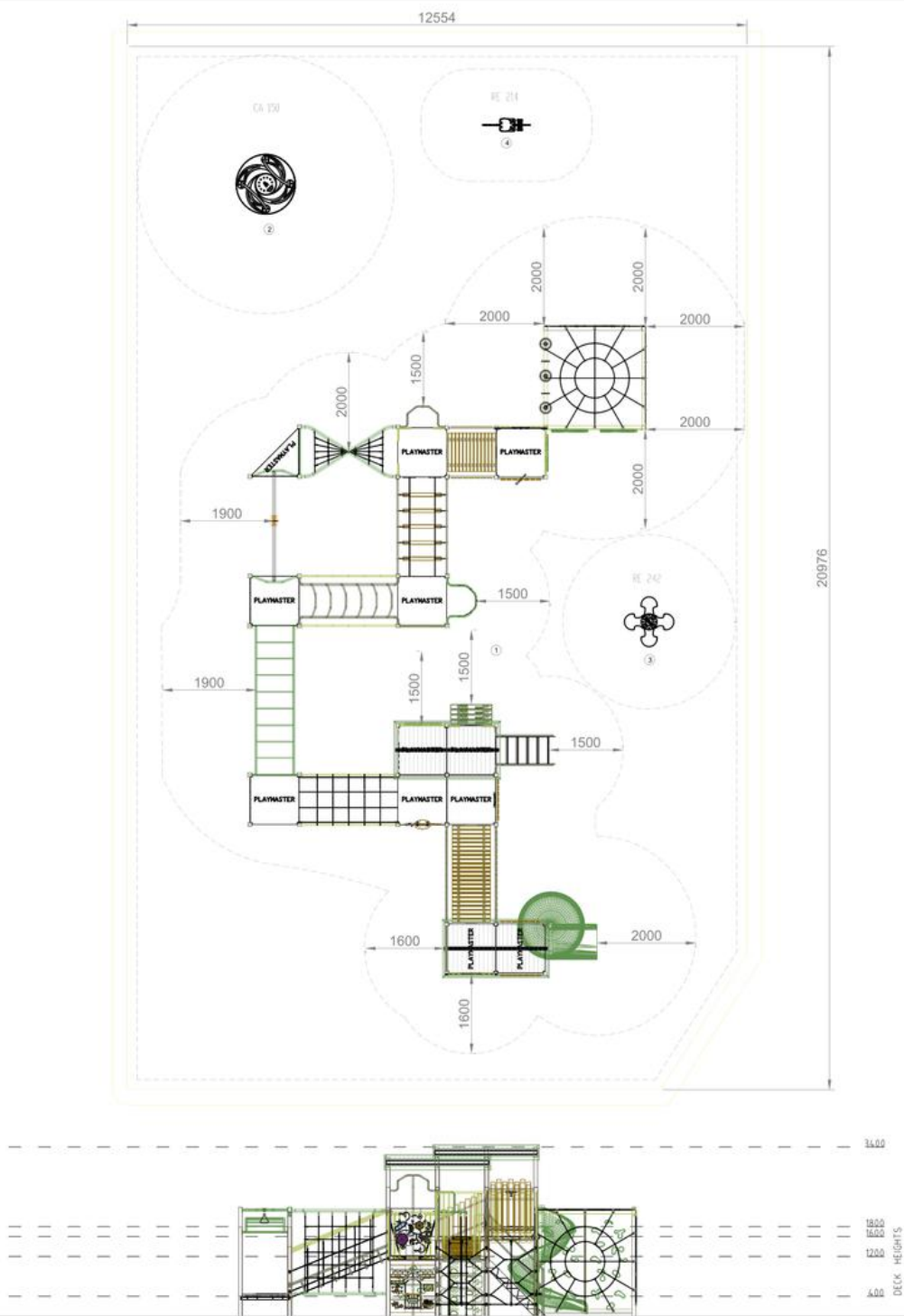

DESIGN FLOOR PLAN & ELEVATIONS

PROPRIETARY & CONFIDENTIALITY ALL INFORMATION CONTAINED WITHIN THIS DRAWING REMAINS THE PROPERTY OF ACTIVE DISCOVERY. REPRODUCTION, IN PART OR WHOLE, IS NOT PERMITTED WITHOUT WRITTEN CONSENT FROM ACTIVE DISCOVERY	REV	DETAILS	DATE	PROJECT:	 	CONTACT DARRYN DEARLOVE BUSINESS DEVELOPMENT MANAGER 0436108262 DARRYN@ACTIVEDISCOVERY.NET.AU		DESIGNED	DATE	SCALE
	A	DESIGN OPTION 1	25/10/23	TOWN OF CLAREMONT JOHN AND JEAN MULDER PARK CLAREMONT 6010				LV	25/10/23	1:30 @ A3
									AD12-003	SHT 1 OF 1

PLAYMASTER COMPONENT LIST

NUMBER	CODE	COMPONENT NAME	QUANT
1	SS4	SPIRAL SLIDE 1800mm	1
2	ER1	ENTRY RAIL	1
3	SKR2	SKILLION ROOF 2000mm	2
4	RB1	RUSTIC BARRIER	2
5	RWC1	ROCK WALL CAGE	6
6	PR40	PIPE RAIL 40nb	8
7	WC16	WEB CLIMBER 1600mm	2
8	RWB2	RUSTIC WAVE BRIDGE	1
9	PLMFMSHOP3	FARM SHOP PLAY PANEL	1
10	PLMSENP6	SENSORY PANEL	1
11	PLMROW	3 IN A ROW GAME PLAY PANEL	1
12	GRW1	STEERING PANEL	1
13	RW12	ROCK WALL 1200mm	1
14	BH1	BARRIER HANDLES (PAIR)	1
15	SS12	SAFETY STAIRS 1200mm	1
16	WW2-8	WEB WALK 2000mm 800 INCLINE	1
17	FF2	FLYING FOX 2000mm	1
18	HC3	HEXI CRAWLER 2m 800 INCLINE	1
19	GC12	GALAXY CLIMBER 1200mm	1
20	WTP2L	WALK THE PLANK 2m LEVEL	1
21	TN20	TRAVERSE NET	1
22	RCR1-4	RUSTIC CARGO RAMP 1m 400 INCLINE	1
23	FP2	FIRE POLE 1200mm	1
24	AC12	ASCEND CLIMBER 1200mm	1
25	RW16	ROCK WALL 1600mm	1
26	SCUBER	SPIDER CUBE WITH ROCK WALLS	1
27	MBA3	MONKEY BAR ARCHED 3000mm	1

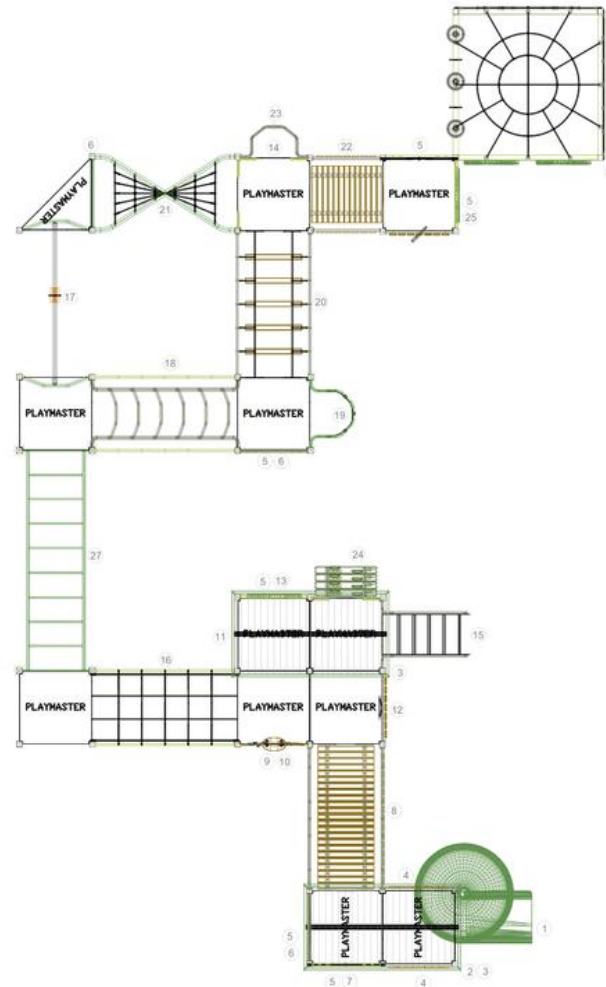

COMPONENT PLAN

0 1.5m 3m 4.5m 6m 7.5m

PROPRIETARY & CONFIDENTIALITY
ALL INFORMATION CONTAINED WITHIN THIS DRAWING REMAINS THE PROPERTY OF ACTIVE DISCOVERY. REPRODUCTION, IN PART OR WHOLE, IS NOT PERMITTED WITHOUT WRITTEN CONSENT FROM ACTIVE DISCOVERY

REV	DETAILS	DATE
A	DESIGN OPTION 1	25/10/23

PROJECT:
TOWN OF CLAREMONT
JOHN AND JEAN MULDER PARK
CLAREMONT 6010



CONTACT:
DARRYN DEARLOVE
BUSINESS DEVELOPMENT MANAGER
0438106282
DARRYN@ACTIVEDISCOVERY.NET.AU



DESIGNED	DATE	SCALE
LV	25/10/23	1:75 @ A3
DWG		SHEET
AD12-003		2 OF 2

CONTACT US

ADDRESS

10 Absolon Street, Palymra,
WA

PHONE

(08) 9359 3344

EMAIL

darryn@activediscovery.net.au

